

# PHE

## Plate heat exchanger

**PHE - 50/75/100/150/175/225/250/275**



Copper soldered plate heat exchanger • Optimum security thanks to double separation-construction • Nominal output of 50 - 275 kW • Maximum working pressure of (25 bar) 2500 kPa • Maximum working temperature heat exchangers: 120°C • Very easy installation • Maintenance friendly because there are no gaskets • Deliverable with additional insulation kit • Different capacity-types are available at request

# Technical specifications

		PHE 50	PHE 75	PHE 100	PHE 150	PHE 175	PHE 225	PHE 250	PHE 275
Power	kW	50	75	100	150	175	225	250	275
Number of plates		20	24	30	40	50	60	70	80
Primary temperature	°C	80/60							
Secondary temperature	°C	10/60							
Primary flow	m <sup>3</sup> /h	2.15	3.23	4.31	6.46	7.53	9.69	10.77	11.85
Secondary flow	m <sup>3</sup> /h	0.86	1.29	1.72	2.58	3.01	3.78	4.31	4.74
Primary pressure drop	kPa	22.7	33.7	37.3	46.4	41.3	48.6	46.2	45.2
Secondary pressure drop	kPa	3.3	5.2	5.9	7.6	6.9	8.2	7.8	7.6
Max. permitted pressure drop	kPa	50							
Max. working pressure									
heat exchangers	bar	25							
Min. working temp. heat exchangers	°C	0							
Max. working temp. heat exchangers	°C	120							
Plate material		AISI 316 L							
Soldering material		copper							
Empty weight	kg	5.0	5.7	6.7	8.4	10.1	11.8	13.5	15.2
Max. chlorine concentration (at 80°C)	mg/kg	50							
Insulation jacket (art. nr.)		0307623(S)	0307623(S)	0307625 (S)	0307625 (S)	0307627(S)	0307627(S)	0307629(S)	0307629(S)
Primary capacity	ltr/channel	0.59	0.72	0.91	1.24	1.56	1.89	2.21	2.54
Secondary capacity	ltr/channel	0.65	0.78	0.98	1.30	1.63	1.95	2.28	2.60

# Dimensions

	PHE 50	PHE 75	PHE 100	PHE 150	PHE 175	PHE 225	PHE 250	PHE 275
A	337	337	337	337	337	337	337	337
C	127	127	127	127	127	127	127	127
E	61	71	85	109	133	157	181	205
G	395	395	395	395	395	395	395	395
H	175	175	175	175	175	175	175	175
I	125	125	170	170	215	215	265	265
M	281	281	281	281	281	281	281	281
N	73	73	73	73	73	73	73	73
1/2 Primary water connection	G 1"	G 1"	G 1"	G 1"	G 1"	G 1"	G 1"	G 1"
3/4 Secondary water connection	G 1"	G 1"	G 1"	G 1"	G 1"	G 1"	G 1"	G 1"

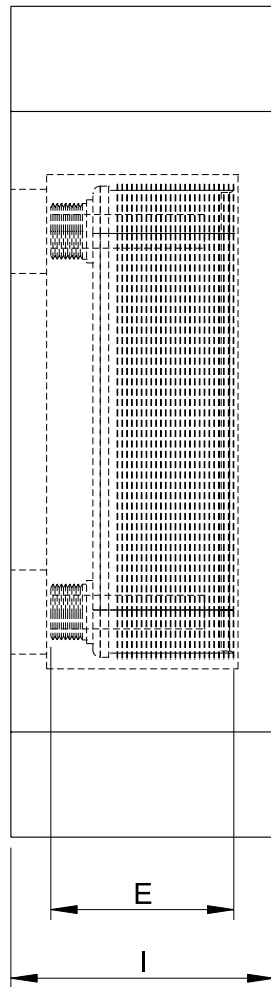
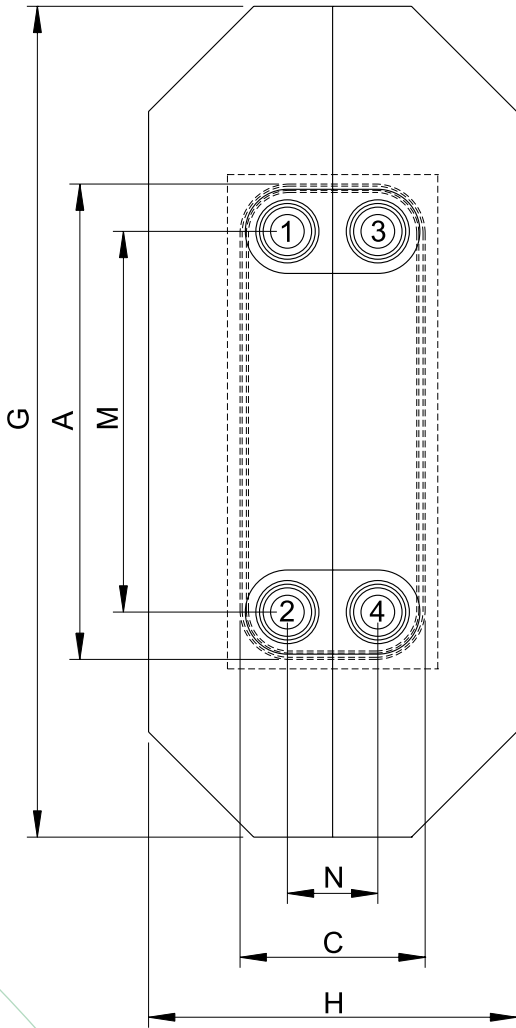

# Electrical diagram

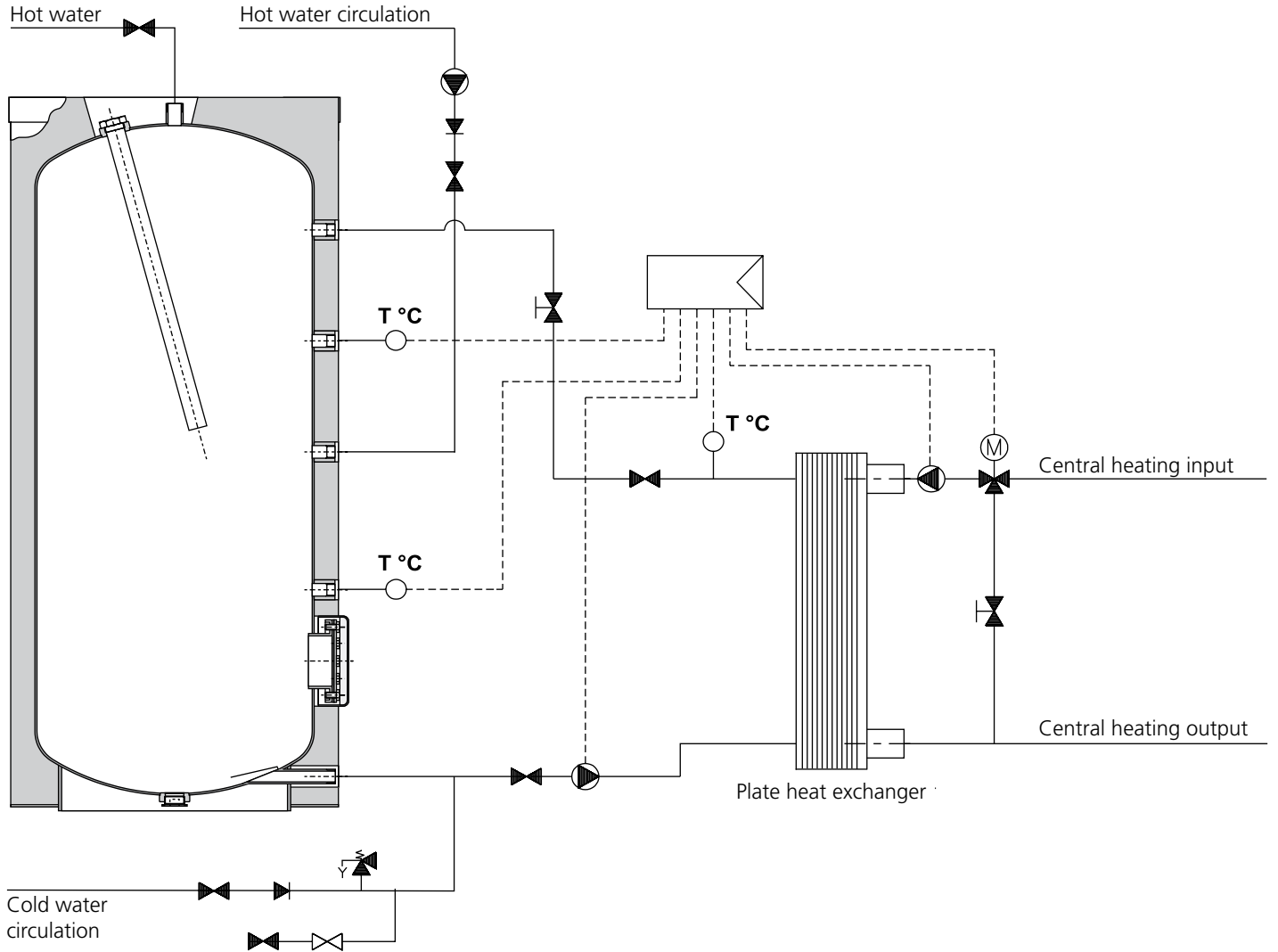

Data subject to change UK/0410/PHE/01  
Terms and conditions apply, please refer to our website.